

## Front View

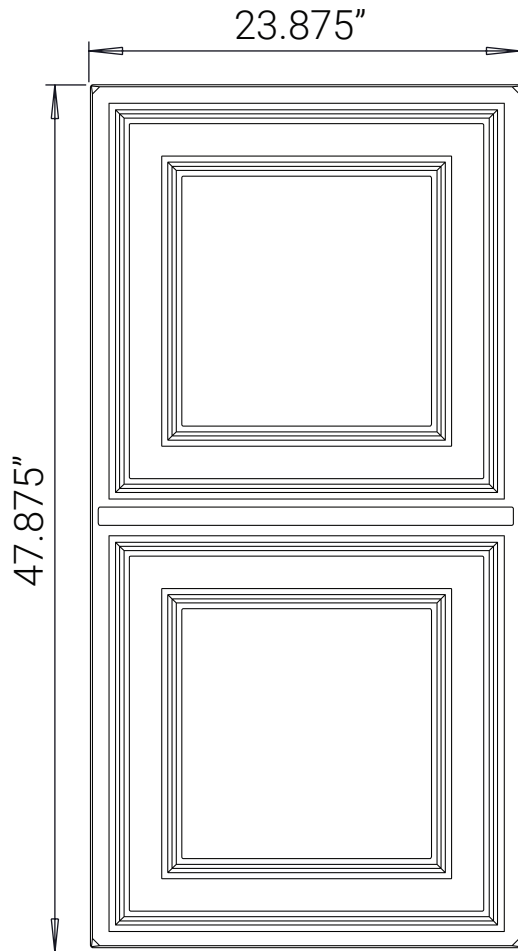

## Side View

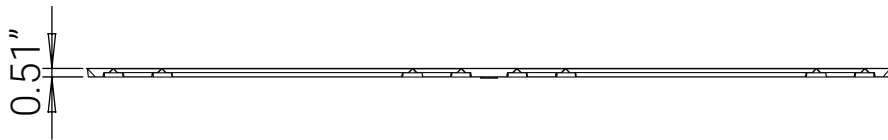

## Isometric View

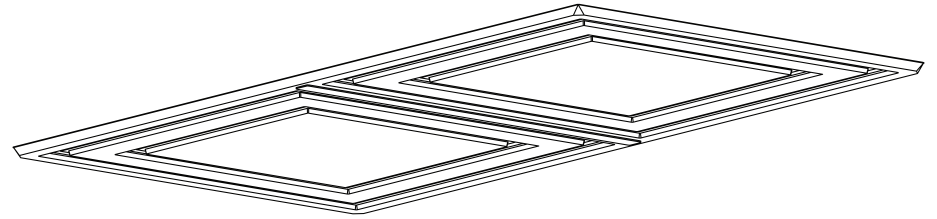

ceilume®

1-800-557-0654  
info@ceilume.com

### Stratford Ceiling Panels

**Part Number:** V1-STRATF-24\*\*\* (3-character color code)

**Size:** 2' x 4' (nominal)

**Material:** 0.013" thick rigid vinyl plastic

**Installation:** 15/16" grid

**Separate Border Tile:** Not required

**Pass-through Sprinklers:** Not recommended

**Drop-out Installation:** Yes

